

## KNORR SN6../7..

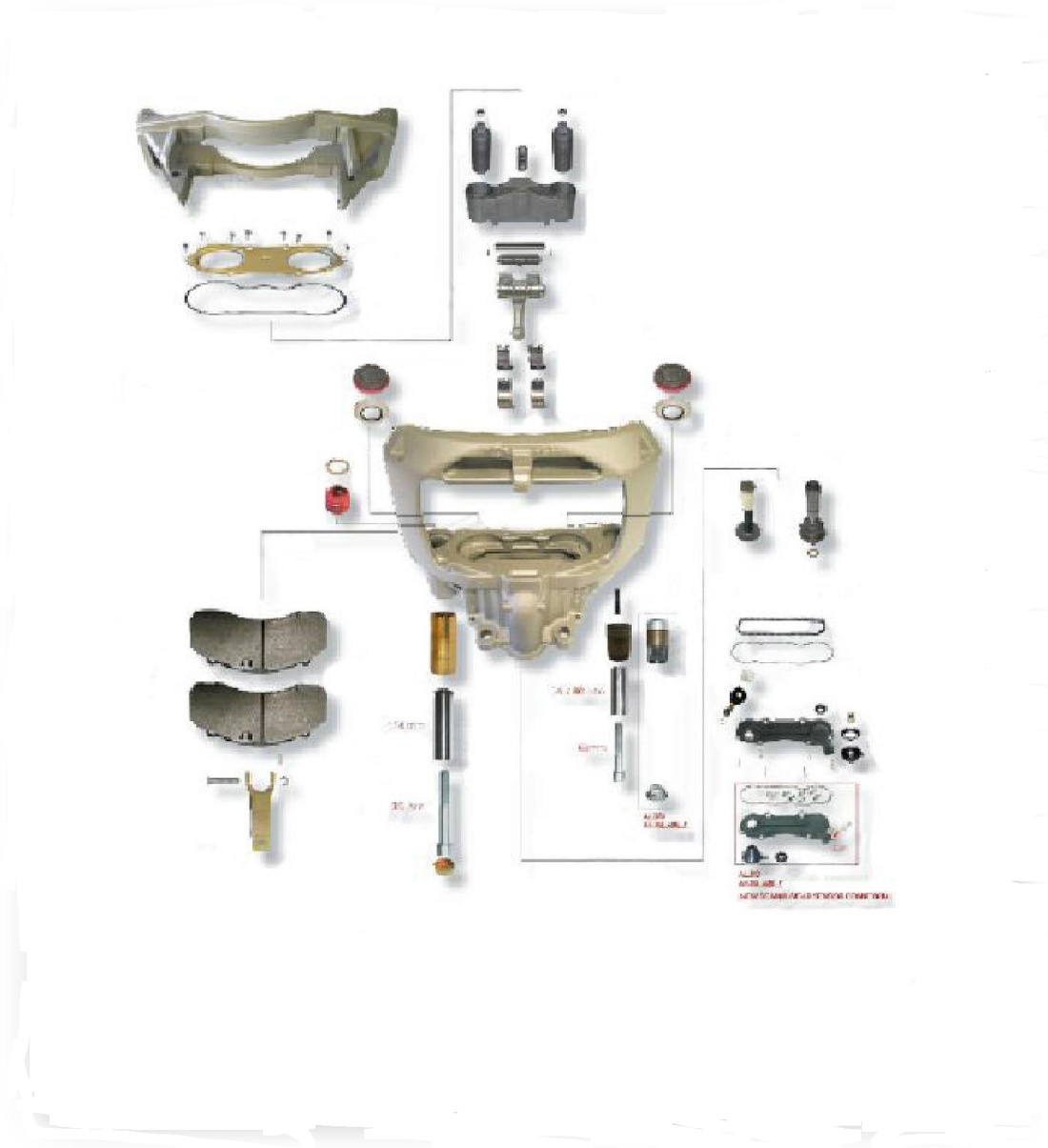

# Knorr Repair Kits - SN6/SN7/SK7 Series

**1005 - SN6/SN7/SK7**

Caliper Roller Bearings



**1008 - SN6/SN7/SK7**

Caliper Calibration Bolt



**1010 - SN6/SN7/SK7**

Caliper Adjusting Mechanism Adapter



**1011 - SN6/SN7/SK7**

Caliper Adjusting Mechanism Wheel Set



**1019 - SN6/SN7/SK7**

Caliper Plastic Cover (without sensor)



**1028 - SN6/SN7/SK7**

Caliper Pad Retainer Repair Kit



**1029 - SN6/SN7/SK7**

Caliper Adjusting Mechanism



**1030 - SN6/SN7/SK7**

Caliper Adjusting Shaft (with spring)



**1031 - SN6/SN7/SK7**

Caliper Chain (29 links)



# Knorr Repair Kits - SN6/SN7/SK7 Series

## 1033 - SN6/SN7/SK7

Caliper Sensor Cover (2 cables inside)



## 1020 - SN6/SN7/SK7

Caliper Sensor Cover (without sensor)

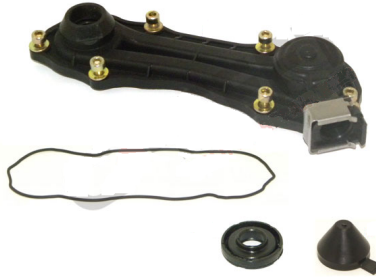

## 1021 - SN6/SN7/SK7

Caliper Plastik Cover (2 cable)

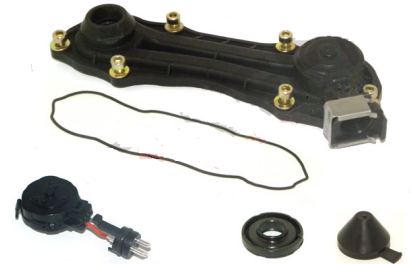

## 1038 - SN6/SN7/SK7

Caliper Piston Repair Kit



## 1066 - SN6/SN7/SK7

Caliper Sensor Cover (2 cable)



## 1185 - SN6/SN7

K000698

Caliper Bush & Guide Repair Kit

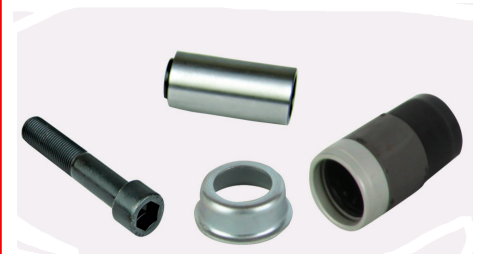

K000472

## 1039 - SN6/SN7/SK7

Caliper Guides & Seals Repair Kit



|      | REF | DESCRIPTION       | DIMENSION          | QTY |
|------|-----|-------------------|--------------------|-----|
| 1039 | 01  | GUIDE PIN (SHORT) | Ø32 x 80 mm        | 1   |
|      | 02  | GUIDE PIN (LONG)  | Ø36 x 114 mm       | 1   |
|      | 03  | BOLT (SHORT)      | M16x1,5 x 80 mm    | 1   |
|      | 04  | BOLT (SHORT)      | M16x1,5 x 85 mm    | 1   |
|      | 05  | BRONZE BUSH       | Ø40 x Ø36 x 82 mm  | 1   |
|      | 06  | METAL-RUBBER BUSH | Ø39 mm (metal end) | 1   |
|      | 07  | INNER BOOT        |                    | 1   |
|      | 08  | CAP               |                    | 1   |
|      | 09  | COVER             | Ø40 mm             | 1   |
|      | 10  | RING              |                    | 1   |

# Knorr Repair Kits - SN6/SN7/SK7 Series

K001915

## 1040 - SN6/SN7/SK7 Caliper Guides & Seals Repair Kit

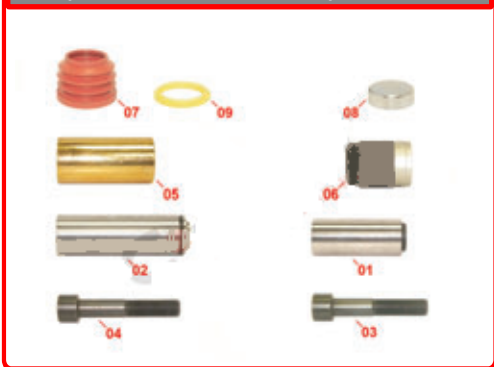

|             | REF       | DESCRIPTION | DIMENSION         | QTY               |   |
|-------------|-----------|-------------|-------------------|-------------------|---|
| <b>1040</b> | <b>01</b> | 1501        | GUIDE PIN (SHORT) | Ø32 x 80 mm       | 1 |
|             | <b>02</b> | 1505        | GUIDE PIN (LONG)  | Ø36 x 114 mm      | 1 |
|             | <b>03</b> | 1513        | BOLT (SHORT)      | M16x1,5 x 80 mm   | 1 |
|             | <b>04</b> | 1514        | BOLT (SHORT)      | M16x1,5 x 85 mm   | 1 |
|             | <b>05</b> | 1521        | BRONZE BUSH       | Ø40 x Ø36 x 82 mm | 1 |
|             | <b>06</b> | 1523        | METAL-RUBBER BUSH | Short version     | 1 |
|             | <b>07</b> | 1531        | INNER BOOT        |                   | 1 |
|             | <b>08</b> | 1543        | COVER             | Ø40 mm            | 1 |
|             | <b>09</b> | 1551        | RING              |                   | 1 |

## 1041 - SN6/SN7/SK7 Caliper Bridge Assembly



|             | REF       | DESCRIPTION | DIMENSION       | QTY         |   |
|-------------|-----------|-------------|-----------------|-------------|---|
| <b>1041</b> | <b>01</b> | 1571        | SPRING          | Ø25 x 49 mm | 1 |
|             | <b>02</b> | 1592        | BRIDGE ASSEMBLY |             | 1 |

## 1042 - SN6/SN7/SK7 Caliper Bridge Assembly



|             | REF       | DESCRIPTION | DIMENSION       | QTY         |   |
|-------------|-----------|-------------|-----------------|-------------|---|
| <b>1042</b> | <b>01</b> | 1571        | SPRING          | Ø25 x 49 mm | 1 |
|             | <b>02</b> | 1593        | BRIDGE ASSEMBLY |             | 1 |

# Knorr Repair Kits - SN6/SN7/SK7 Series

## 1043 - SN6/SN7/SK7

Caliper Lever (Angle 0° - 126 mm)



----- 126 mm -----

## 1044 - SN6/SN7/SK7

Caliper Lever (Angle 0° - 113 mm)



----- 113 mm -----

## 1046 - SN7/SK7

Caliper Cover



## 1045 - SN7/SK7

Caliper Cover



|      |    | REF  | DESCRIPTION       | DIMENSION  | QTY |
|------|----|------|-------------------|------------|-----|
| 1045 | 01 | 1596 | COVER WITH GASKET |            | 1   |
|      | 02 | 1573 | BOLT              | M8 x 16 mm | 8   |

K010603/K001300

## 1127 - SN6/SN7/SK7

Caliper Pistons & Seals Repair Kit



|      |    | REF  | DESCRIPTION            | DIMENSION         | QTY |
|------|----|------|------------------------|-------------------|-----|
| 1127 | 01 | 1534 | TAPPET & BOOT ASSEMBLY | Ø69 mm            | 2   |
|      | 02 | 1538 | INNER SEAL             |                   | 2   |
|      | 03 | 1520 | TAPPET BUSH            | Ø18 x Ø16 x 10 mm | 2   |

# Knorr Repair Kits - SN6/SN7/SK7 Series

## 1164 - SN6/SN7/SK7

Caliper Guides & Seals Repair Kit



|             | REF       | DESCRIPTION | DIMENSION         | QTY               |   |
|-------------|-----------|-------------|-------------------|-------------------|---|
| <b>1164</b> | <b>01</b> | 1504        | GUIDE PIN (SHORT) | Ø36 x 64 mm       | 1 |
|             | <b>02</b> | 1505        | GUIDE PIN (LONG)  | Ø36 x 114 mm      | 1 |
|             | <b>03</b> | 1511        | BOLT (SHORT)      | M16x1,5 x 70 mm   | 1 |
|             | <b>04</b> | 1514        | BOLT (SHORT)      | M16x1,5 x 85 mm   | 1 |
|             | <b>05</b> | 1521        | BRONZE BUSH       | Ø40 x Ø36 x 82 mm | 1 |
|             | <b>06</b> | 1527        | GUIDE SLEEVE      | Ø40 x Ø36 x 20 mm | 1 |
|             | <b>07</b> | 1531        | INNER BOOT        |                   | 2 |
|             | <b>08</b> | 1543        | COVER             | Ø40 mm            | 1 |
|             | <b>09</b> | 1544        | COVER             | Ø40 mm (long)     | 1 |
|             | <b>10</b> | 1551        | RING              |                   | 2 |

## 1166 - SN6/SN7/SK7

Caliper Adjuster Cap Kit

38 mm



|             | REF       | DESCRIPTION | DIMENSION         | QTY |    |
|-------------|-----------|-------------|-------------------|-----|----|
| <b>1166</b> | <b>01</b> | 1557        | ADJUSTER CAP      |     | 10 |
|             | <b>02</b> |             |                   |     |    |
|             | <b>03</b> | 1010        | MECHANISM ADAPTER |     | 10 |

## 1188 - SN6/SN7/SK7

Caliper Adjuster Cap Kit

35 mm



|             | REF       | DESCRIPTION | DIMENSION         | QTY |    |
|-------------|-----------|-------------|-------------------|-----|----|
| <b>1188</b> | <b>01</b> | 1561        | ADJUSTER CAP      |     | 10 |
|             | <b>02</b> | 1010        | MECHANISM ADAPTER |     | 10 |

# SN6/SN7/SK7 Series

**1176 - SN6/SN7/SK7**  
Caliper Lever (Angle 12° - 123 mm)



----- 123 mm -----

**1178 - SN6/SN7/SK7**  
Caliper Lever (Angle 0° - 113 mm)



----- 113 mm -----

**1179 - SN6/SN7/SK7**  
Caliper Lever (Angle 12° - 122 mm)



----- 122 mm -----

**1181 - SN6/SN7/SK7**  
Caliper Guides & Seals Repair Kit



|      | REF | DESCRIPTION       | DIMENSION         | QTY |
|------|-----|-------------------|-------------------|-----|
| 1181 | 01  | GUIDE PIN (SHORT) | Ø32 x 80 mm       | 1   |
|      | 02  | GUIDE PIN (SHORT) | Ø34 x 80 mm       | 1   |
|      | 03  | GUIDE PIN (LONG)  | Ø36 x 114 mm      | 1   |
|      | 04  | BOLT (SHORT)      | M16x1,5 x 80 mm   | 1   |
|      | 05  | BOLT (LONG)       | M16x1,5 x 85 mm   | 2   |
|      | 06  | BRONZE BUSH       | Ø40 x Ø36 x 82 mm | 1   |
|      | 07  | METAL-RUBBER BUSH | short version     | 1   |
|      | 08  | RUBBER BUSH       |                   | 1   |
|      | 09  | INNER BOOT        |                   | 1   |
|      | 10  | STEEL CAP         |                   | 1   |
|      | 11  | COVER             | Ø40 mm            | 1   |
|      | 12  | RING              |                   | 1   |
|      | 13  | O-RING            |                   | 1   |

**1182 - SN6/SN7/SK7**  
Caliper Lever Bearing



**1068 - SN6/SN7/SK7**  
Caliper Plug Set

